

HTD

Echo Dot Mount and Adapter Kit

for Echo Dot Gen 5

Do NOT substitute power supply or adapters.
Does NOT work with other POE injectors or switches.

Our innovative solution provides all you need to install your Amazon Echo Dot Gen 5 (also works with Gen 3 & 4) into the ceiling or wall of any room and extend Alexa's Bluetooth audio output into your own speakers. A single Cat5e (or higher) cable, provides power for the Echo Dot and BTX bluetooth receiver while simultaneously carrying its audio signal back to your equipment over a distance up to 240 feet.

In-Ceiling mounting bracket
for Echo Dot Gen 5
(also works for Gen 3 or Gen 4)



Adapter and BTX connect
with Cat5 or higher cable
up to 240 feet apart



Power In

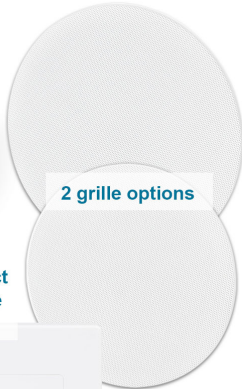

2 grille options

Bluetooth Receiver (BTX)
sits (or mounts) behind the
ceiling within 1 foot
of mounting bracket

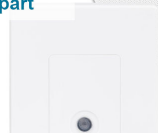

Power Supply

RCA cable for
AUDIO OUT



Power cable
for Dot

What's Included:

Ceiling/Wall mount bracket that securely holds Amazon Echo Dot Gen 3, 4, or 5.

Two grille cover options: one that reveals a modest trim similar to canned lighting; one "trimless" design that covers the entire mount

UL listed 24V power supply

Adapter with built-in stereo audio balun, RCA stereo outputs, and power input.

BTX Bluetooth receiver with built-in stereo audio balun and 12v power output for Echo Dot Gen 3, 4, or 5.

How to Install:

Install Echo Dot Gen 3 into the Dot Bracket

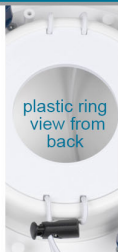
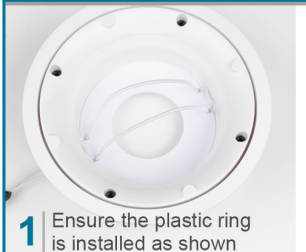

2 Insert Dot into bracket. Align connections to hole.



Install Echo Dot Gen 5 (or 4) into the Dot Bracket

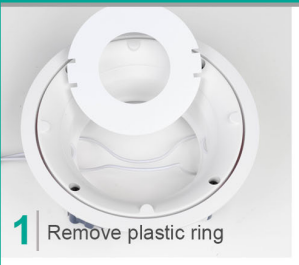

3 Insert Dot from the back. Tighten cord, then proceed to installation instructions.



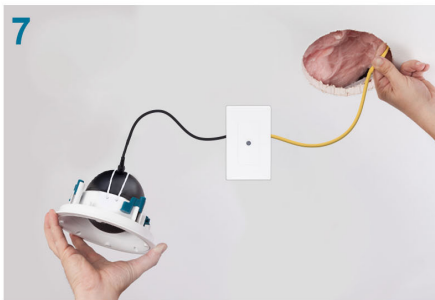

NOTE:
The BTX Bluetooth receiver can "float" behind the wall/ceiling or be mounted in a junction box that is within one foot of the installed Echo Dot.

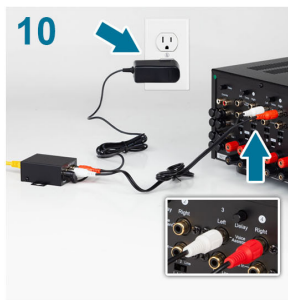

We're here to help!
www.htd.com/contact-us
M-F 8am-6pm Central
972-312-9900

Best Uses:

Use the Alexa app to pair the Echo Dot to the BTX Bluetooth receiver. Use the Echo Dot's built-in microphones to issue commands, but transfer the audio to your centrally located equipment.

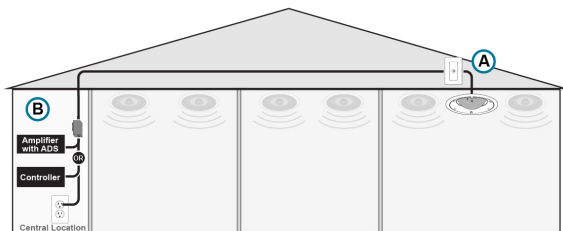

Whole-House Audio System

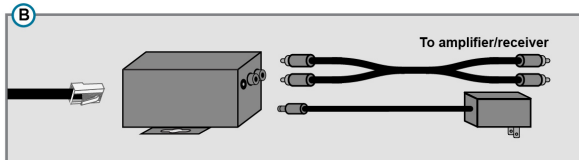
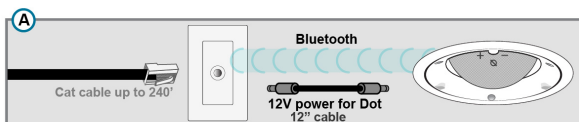

Connect to a Whole House Audio System.

The Echo Dot becomes a source that you can control by voice (and within the Alexa app) and easily make available to other zones in the home.

Connect to Any Amplifier with ADS™ (Auto Detect and Switch).

When connected to the primary or Voice Assistant input, the audio from the Echo device is heard whenever you need it, even if you were already listening to a different source.

DMA-1240ADS

12-Channel Amplifier

<https://www.htd.com/DMA-1240ADS>

PLA-240ADS

Stereo Amplifier

<https://www.htd.com/auto-switching-amp>



Go here for more info about this product

The blue LED blinks for around 3 minutes upon initial power-on, then turns off. A Bluetooth device can be paired during this period or anytime later, provided it's not already paired to another device. Once paired, the LED stays lit. When unpaired, it blinks for around 3 minutes before turning off, but remains available for pairing.