

HTD

Home Theater Direct

A-2050
Stereo Amplifier
Owner's Manual

Home Theater Direct, Inc.
www.htd.com

Expert Support:
866-HTD-AUDIO (483-2834)
info@htd.com

Safety Instructions for the A-2050

Warning - To reduce the risk of fire or shock, do not expose this appliance to rain or moisture.

Caution - To reduce the risk of fire or shock, do not remove the cover or back. No user serviceable parts inside. Refer servicing to qualified service personnel.

Caution - To prevent electric shock, match wide blade of plug to wide slot, fully insert.



The lightning flash with arrowhead symbol, within an equilateral triangle, is intended to alert the user to the presence to un-insulated dangerous voltage within the product's enclosure that may be of sufficient magnitude to constitute a risk of electrical shock to persons.



The exclamation point within an equilateral triangle is intended to alert the user to the presence of important operating and maintenance (servicing) instructions in the literature accompanying this appliance.



Read Instructions

All safety and operating instructions should be read before the appliance is operated.

Retain Instructions

The safety and operating instructions should be adhered to.

Heed Warnings

All warnings on the appliance and in the operating instructions should be adhered to.

Follow Instructions

All operating and use instructions should be followed.

Water and Moisture

The appliance should not be used near water. For example, near a bathtub, washbowl, kitchen sink, laundry tub, in a wet basement, or near a swimming pool, etc.

Ventilation

The appliance should be situated so that its location or position does not interfere with its proper ventilation. For example, the appliance should not be situated on a bed, sofa, rug, or similar surface that may block the ventilation openings: or placed in a built-in situation, such as a bookcase or cabinet that may impede the flow of air through the ventilation openings.

Heat

The appliance should be situated away from heat sources such as radiators, heat registers, stoves, or other appliances (including amplifiers) that produce heat.

Power Sources

The appliance should be connected to a power supply only of the type described in the operating instructions or as marked on the appliance.

Grounding or Polarization

Precautions should be taken so that the grounding or polarization means of an appliance is not defeated.

Power Cord Protection

Power supply cords should be routed so that they are not likely to be walked on or pinched by items placed on or against them, paying particular attention to cords at plugs, convenience receptacles, and the point where they exit from the appliance.

Cleaning

The appliance should be cleaned only as recommended by the manufacturer.

Power Lines

An outdoor antenna should be located away from power lines.

Non-Use Periods

The power cord of the appliance should be unplugged from the outlet when left unused for long periods of time.

Object and Liquid Entry

Care should be taken so that objects do not fall and liquids are not spilled into the enclosure through openings.

Damage Requiring Service

The appliance should be serviced by qualified personnel when: a) the power supply cord or the plug has been damaged: b) objects have fallen, or liquid spilled into the appliance: c) the appliance has been exposed to rain: d) the appliance does not appear to operate normally or exhibits a marked change in performance or e) the appliance has been dropped, or the enclosure damaged.

Servicing

The user should not attempt to service the appliance beyond that described in the operating instructions. All other servicing should be referred to qualified service personnel.

Product Servicing

If your system fails to operate properly, please contact HTD directly for further assistance, at 1-866-483-2834.

Additional information, including detailed specifications for each model, can be found on our website, www.htd.com. Thanks again for choosing Home Theater Direct!

If you have any questions, we can be reached at...
info@htd.com or toll free 1-866-HTD-AUDIO (483-2834)

Thank you for giving Home Theater Direct the chance to win your business! We are confident you will find that HTD offers an outstanding combination of performance and value in everything we make. To ensure you get the most out of your new amplifier, please take a moment to read this manual before you get started. Should you lose this manual, you can always download or print a copy from www.htd.com.

Introduction

The A-2050 Multi-Source Stereo Amplifier is an ideal solution for affordably expanding great sounding music throughout your home. Multi-source features are built around a high current, two-channel (stereo) amplifier that is built solid with a large toroidal transformer that produces a warm, full-bodied sound guaranteed to impress even the most fastidious listener.

Select between 2 stereo input sources using the touch-buttons on the front of the unit. Binding posts on the back of the A-2050 allow for easy connection of a single pair, or multiple pairs, of 8 ohm speakers. Because the A-2050 is stable with a 4 ohm load, two pairs of speakers can be connected without the need for impedance matching stereo volume controls.

Save on your utility bill by using the Auto On-Off switch to automatically have the A-2050 turn on when the source selected is active and return to stand-by mode when no source signal is sensed for several minutes.

Product Features

Power Selection Switch, Power Button, and Power Indicator Light

The Power Selection Switch is found on the back of the unit. It includes two settings that will affect how the unit is turned on and off.

- **AUTO ON** - the unit will turn ON when an input signal is sensed by the source that is selected and will go into STAND-BY after several minutes of no signal. The Power Button should be in the IN position. If the Power Button is in the OUT position, the unit will not turn on.
- **AUTO OFF** - allows the user to manually turn the unit ON and OFF by pushing the power button IN or OUT on the front panel.

The Power Indicator Light will be dim blue when the unit is in stand-by mode and bright blue when the unit is active. The Power Indicator Light will not be lit when the Power Button is in the OUT position.

Product Features (cont.)

Source Selection Buttons and Stereo Inputs

The A-2050 allows for easy selection of up to 2 stereo sources. Sources are connected using standard RCA-type patch cables (sold separately) to the Stereo Inputs located on the back of the unit. To select a source, simply touch one of the Source Selection Buttons located on the front of the unit. The indicator light directly above the source that is selected will be illuminated.

Source Output

Use the Source Output RCA-type connectors to connect to an additional amplifier. The signal from whichever source (1 or 2) is selected is output at a fixed level. So the volume of the second amplifier is independent of the volume of the A-2050.

Mode Selection Switch

- **Stereo** - (most common) the left speaker will play the left channel of a stereo recording; the right speaker will play the right side of a stereo recording.
- **Mono** - both speakers will play the sum of the left and right channel of a stereo recording.
- **Bridged** - Can only be used with one 8 ohm speaker. This speaker gets connected to the outer-most binding posts. The speaker will play the right channel input of whichever source is selected.

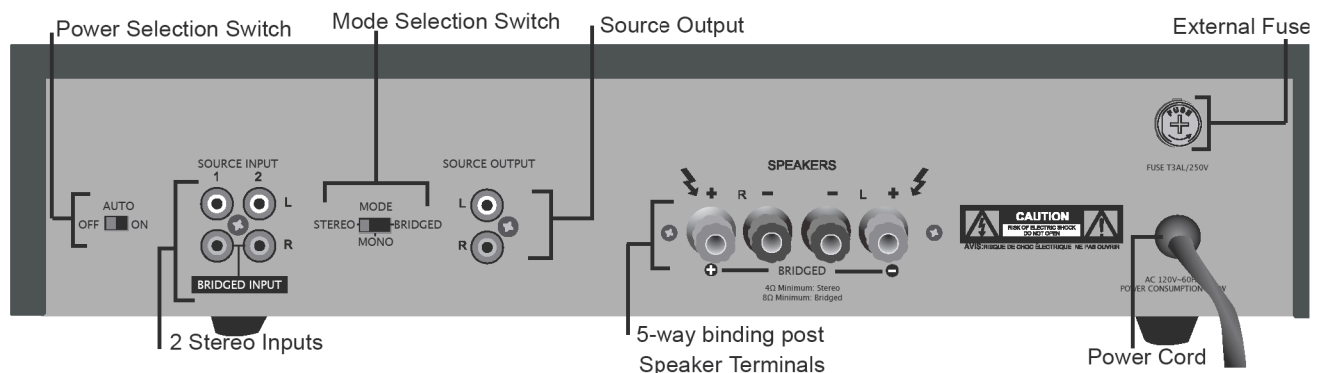
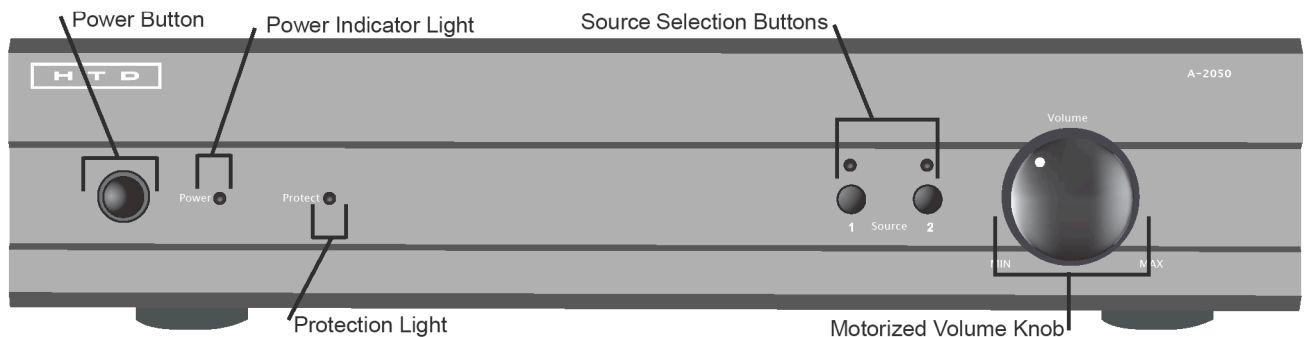

Product Features (cont.)

Volume Knob

The volume knob located on the front of the unit equally controls the output volume level of the speakers connected to the Left and Right Speaker Terminals on the back of the unit.

When using the unit in combination with external volume controls (see figures 2, 3, and 4 in the Speaker Connection section), it is best to set and leave the Volume Knob to a level that equals the maximum listening level you want in the rooms that contain the speakers. In other words, while playing your favorite source, start with the Volume Knob turned all the way down (counter-clockwise) and the volume knobs on the volume controls turned all the way up. Then, gradually turn up the Volume Knob (on the A-2050) until the maximum listening level is achieved. In this way, the amplifier is never using more power than is ever necessary and the volume for each pair of speakers can be adjusted using the external volume controls.

Speaker Cable Connections

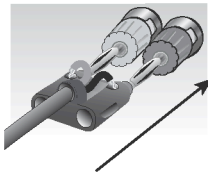

Banana Plug

Make sure binding posts are tightened then push in banana plug.

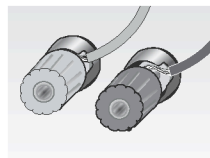

Bare Wire

Rotate binding post counter-clockwise to reveal "eye". Strip back 3/8" insulation from cable. Tightly twist copper wire and insert into "eye". Rotate binding post clockwise to tighten.

Be sure to maintain polarity (Speaker + to Amplifier +, Speaker - to Amplifier -)

Speaker Connections

Figure 1 - Two Pairs of Speakers, No External Volume Control

Two pairs of 8 ohm speakers can be connected to the A-2050 without the need for impedance matching stereo volume controls.

Figure 1 shows two pair of 8 ohm speakers connected in parallel.

The resulting impedance is 4 ohms which is acceptable.

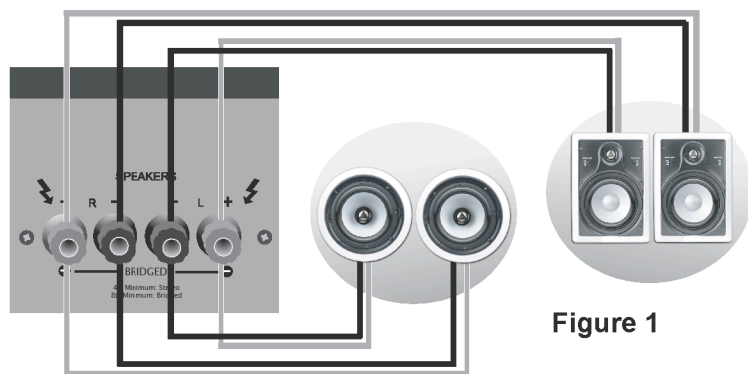

Figure 1

Figure 2 and Figure 3- Two Pairs of Speakers with External Volume Control(s)

Figure 2 shows one impedance matching stereo volume control connected to two pairs of 8 ohm speakers. Figure 3 shows two impedance matching stereo volume controls each connected to one pair of 8 ohm speakers. In both cases the impedance switches on the volume controls are set to the "X1" position (times one equals no impedance correction). In both cases, the resulting impedance is 4 ohms which is acceptable.

Speaker Connections (cont.)

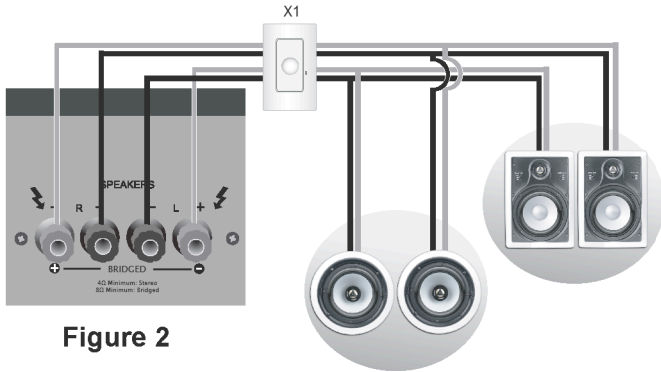

Figure 2

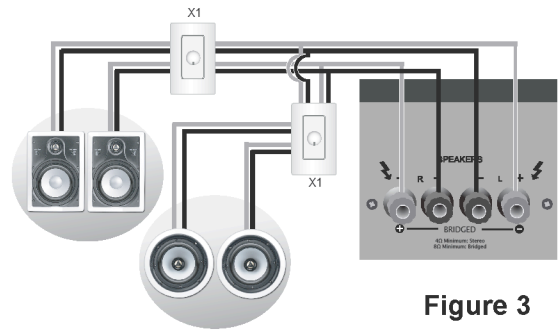

Figure 3

Figure 4 - Multiple Pairs of Speakers with Multiple Impedance Matching Stereo Volume Controls*

When connecting more than two pairs of 8 ohm speakers to the A-2050, it is necessary to use impedance matching volume controls in order to correct for the impedance load placed on the amplifier. Figure 4 shows four pairs of speakers connected to the A-2050. When four pairs of 8 ohm speakers are connected in parallel (as shown), the impedance load is reduced to 2 ohms. By setting the impedance matching stereo volume controls to X2, the impedance is brought back up to a safe level of 4 ohms. Alternatively, you could also connect four pairs of speakers to only one volume control set to X2. The resulting impedance will be 4 ohms which is acceptable. Note that it is the total number of speakers that are connected to the same amplifier that determines this position as long as all speakers at some point pass through one volume control. The total number of volume controls is irrelevant.

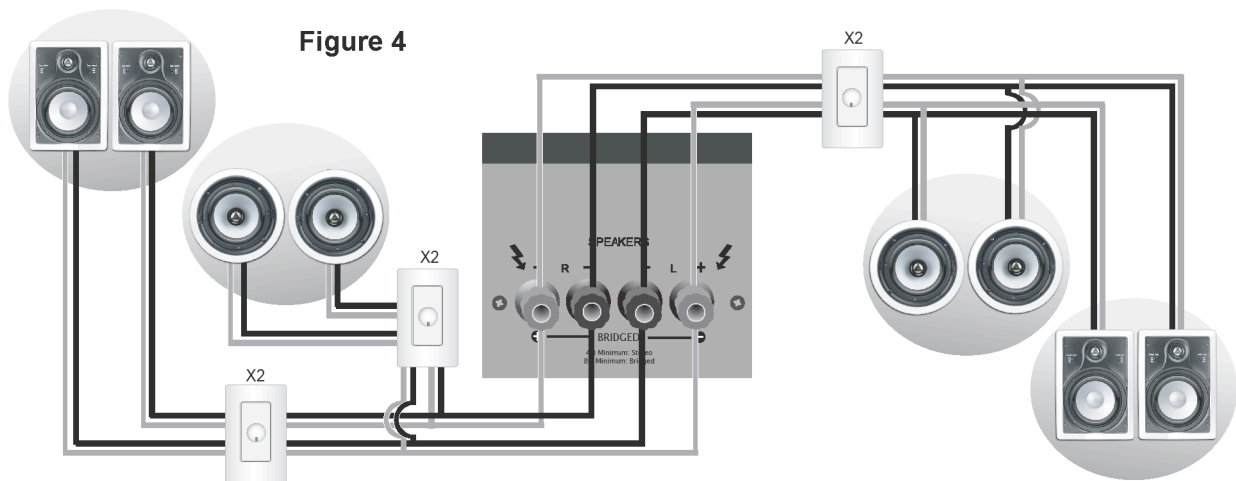

Figure 4

*While it is possible to connect more than four pairs of speakers to the A-2050 by increasing the impedance matching multiple on the volume controls, better performance is achieved by using multiple A-2050s or a multi-channel amplifier when connecting five or more pairs of speakers.

Specifications:

Stereo input sources	2
8 ohms RMS Watts Per Channel (both channels driven)	50
4 ohms RMS Watts Per Channel (both channels driven)	75
Total Harmonic Distortion (THD) 20 Hz - 20 kHz	
8 ohms	.04%
4 ohms	.06%
Frequency response	5 Hz - 65 kHz
Dimensions (HxWxD)	3.875" x 16.75" x 11" (rackmount width is 19")
Net Weight	12.3 lbs.

Warranty

All HTD electronics carry a two-year parts and labor warranty. Warranty registration occurred automatically at the time your order was placed. There is no need to complete or mail in additional paperwork.

If you have any questions, we can be reached at...
info@htd.com or toll free 1-866-HTD-AUDIO (483-2834)

HTD

Home Theater Direct, Inc.
www.htd.com

Expert Support:
Toll free: 866-HTD-AUDIO (483-2834)
info@htd.com